

Service
Service
Service

Service Manual

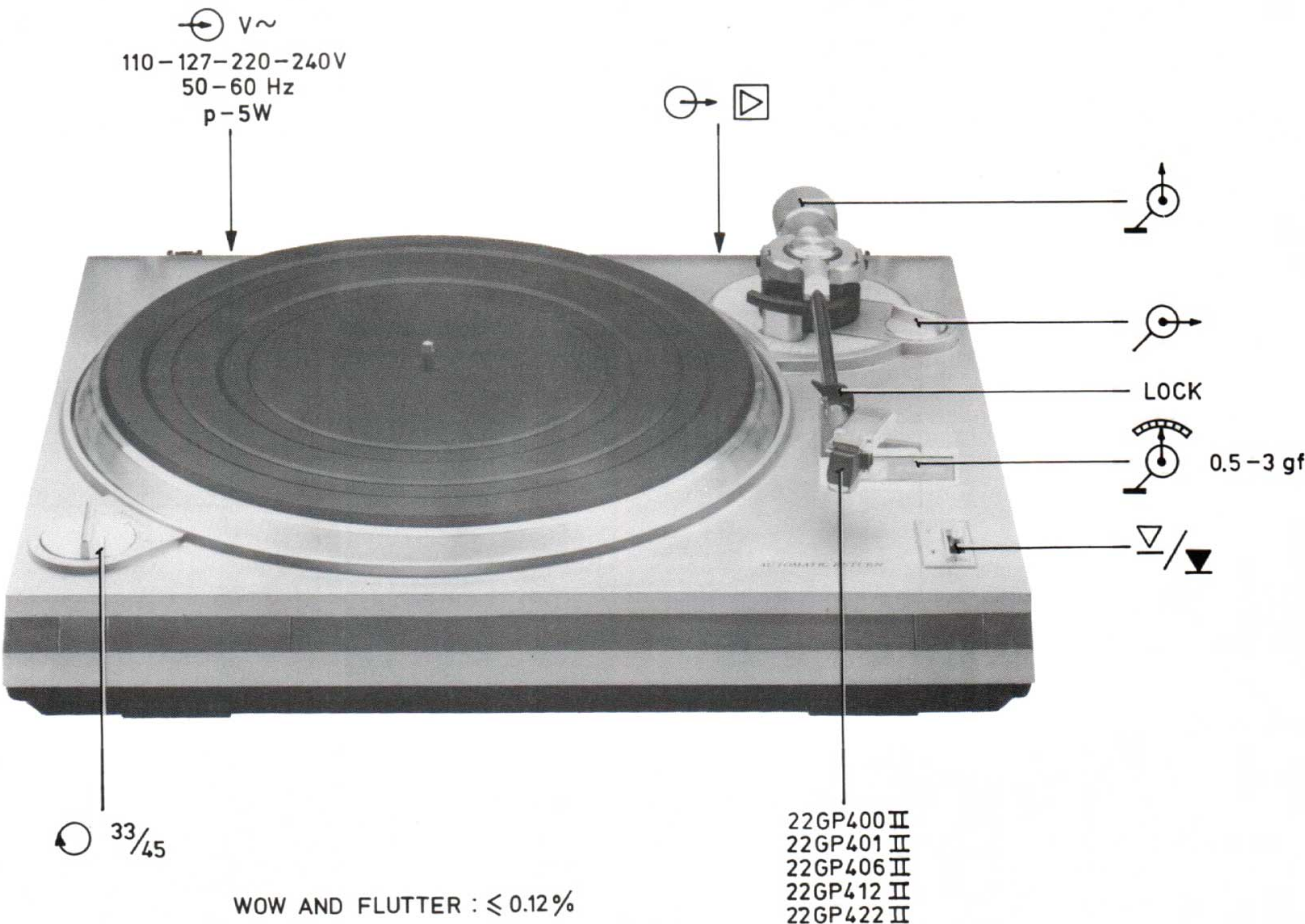

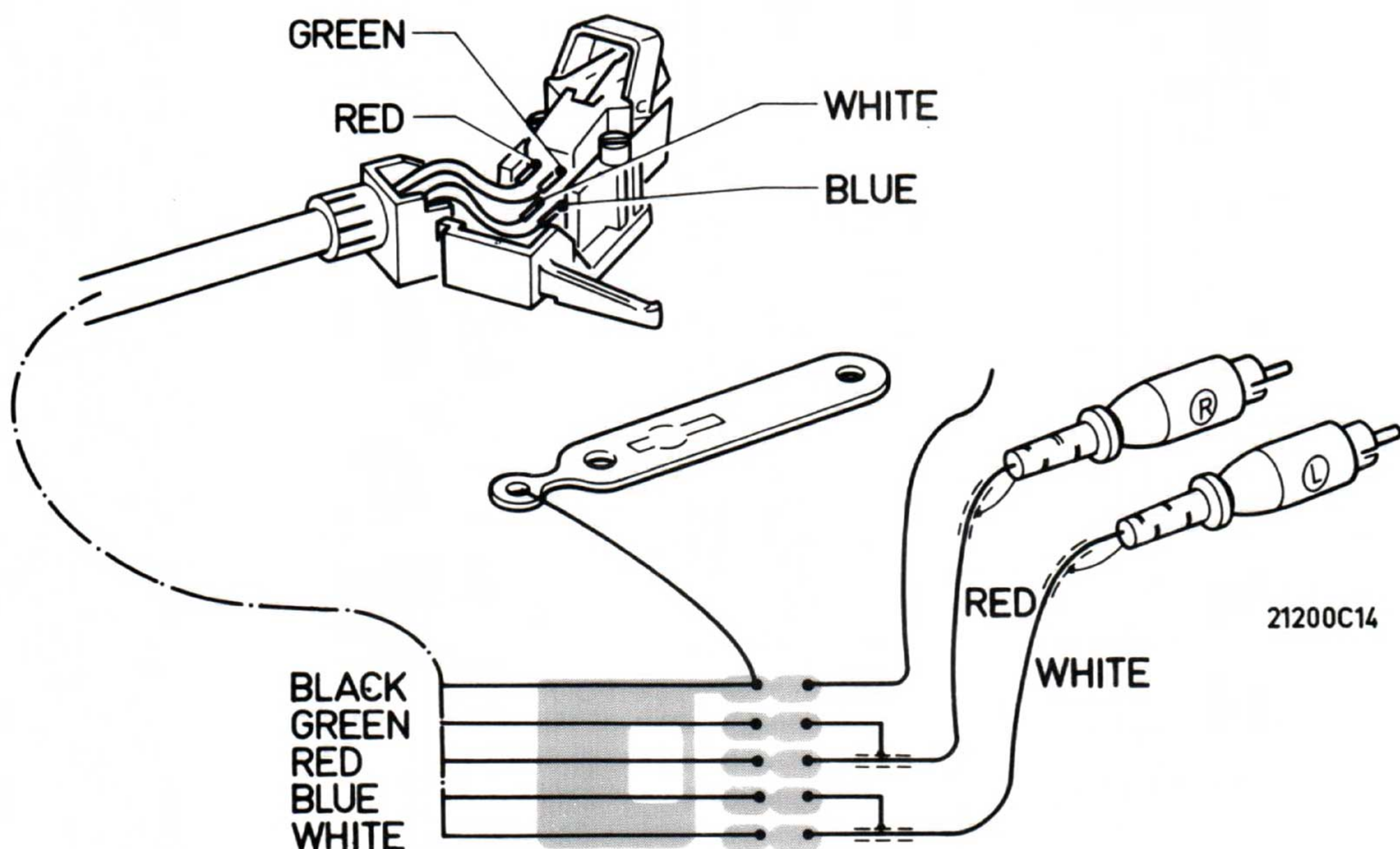

Fig. 7

GB

Safety regulations require that the set be restored to its original condition and that parts which are identical with those specified, be used.

NL

Veiligheidsbepalingen vereisen, dat het apparaat bij reparatie in zijn oorspronkelijke toestand wordt teruggebracht en dat onderdelen, identiek aan de gespecificeerde, worden toegepast.

F

Les normes de sécurité exigent que l'appareil soit remis à l'état d'origine et que soient utilisées les pièces de rechange identiques à celles spécifiées.

D

Bei jeder Reparatur sind die geltenden Sicherheitsvorschriften zu beachten. Der Originalzustand des Geräts darf nicht verändert werden; für Reparaturen sind Original-Ersatzteile zu verwenden.

SF

Korjatessa laitetta on turvallisuussyistä ehdottomasti eneteltävä oikein ja käytettävä tehtaan määräämiä alkuperäisvaraosia.

I

Le norme di sicurezza esigono che l'apparecchio venga rimesso nelle condizioni originali e che siano utilizzati i pezzi di ricambio identici a quelli specificati.

S

Säkerhetsbestämmelserna kräver att varje reparation skall utföras korrekt med hänsyn till ursprunglig placering av komponenter, ledningar etc. och med användning av föreskrivna reservdelar.

DK

Myndighedernes sikkerheds- og radiostøjbestemmelser kræver, at enhver reparation skal udføres korrekt m.h.t. overholdelse af originalplacering og montering af komponenter, ledningsbundter, etc., og ved anvendelse af de foreskrevne reservedele.

N

Sikkerhetsbestemmelser kreves at apparatet blir gjenopprettet til original utførelse og at deler som er identiske med de som er spesifisert, blir benyttet.

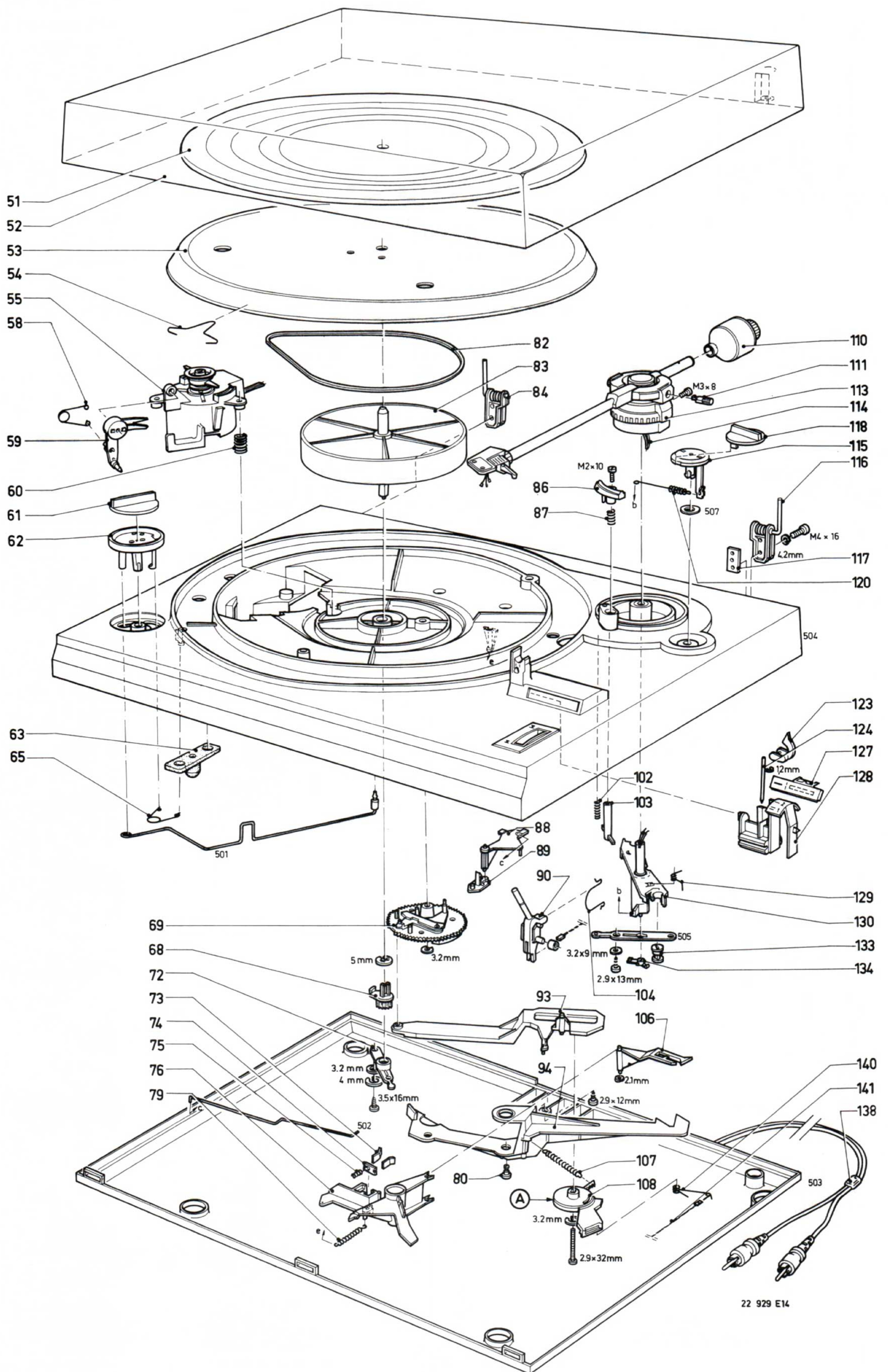

22 929 E14

| | | | | | |
|----|----------------|---------|----------------|-----|----------------|
| 51 | 4822 466 50133 | 80 | 4822 462 71061 | 114 | 4822 323 50054 |
| 52 | 4822 462 71192 | 82 | 4822 358 30279 | 115 | 4822 413 40961 |
| 53 | 4822 528 10405 | 83 | 4822 402 60735 | 116 | 4822 417 10673 |
| 54 | 4822 492 61215 | 84 | 4822 417 10674 | 117 | 4822 417 10544 |
| 55 | 4822 361 20187 | 86 | 4822 402 60736 | 118 | 4822 413 40962 |
| 58 | 4822 492 31654 | 87 | 4822 492 51321 | 120 | 4822 492 31655 |
| 59 | 4822 402 60726 | 88 | 4822 402 60729 | 123 | 4822 402 60727 |
| 60 | 4822 492 50845 | 89 | 4822 402 60633 | 124 | 4822 535 91165 |
| 61 | 4822 413 40959 | 90 | 4822 413 30899 | 127 | 4822 381 10519 |
| 62 | 4822 413 40958 | 93 | 4822 402 60731 | 128 | 4822 691 30088 |
| 63 | 4822 462 40407 | 94 | 4822 402 50156 | 129 | 4822 492 31661 |
| 65 | 4822 492 31654 | 102 | 4822 492 51319 | 130 | 4822 535 60051 |
| 68 | 4822 522 20161 | 103 | 4822 402 60728 | 133 | 4822 528 30234 |
| 69 | 4822 522 31312 | 104 | 4822 492 62278 | 134 | 4822 402 60686 |
| 72 | 4822 520 10442 | 106 | 4822 402 50158 | 138 | 4822 321 20384 |
| 73 | 4822 290 80389 | 107 | 4822 492 51322 | 140 | 4822 492 62279 |
| 74 | 4822 290 80388 | 108 | 4822 402 60737 | 141 | 4822 321 30221 |
| 75 | 4822 492 51318 | 110 | 4822 691 30089 | | |
| 76 | 4822 402 50157 | 111 | 4822 520 10441 | | |
| 79 | 4822 492 51322 | 113+111 | 4822 251 70179 | | |

Lubricating Instruction:

- (A)
 Silicon oil 100.000 CST
 4822 390 80113
 item 108

AUTOMATIC STOP

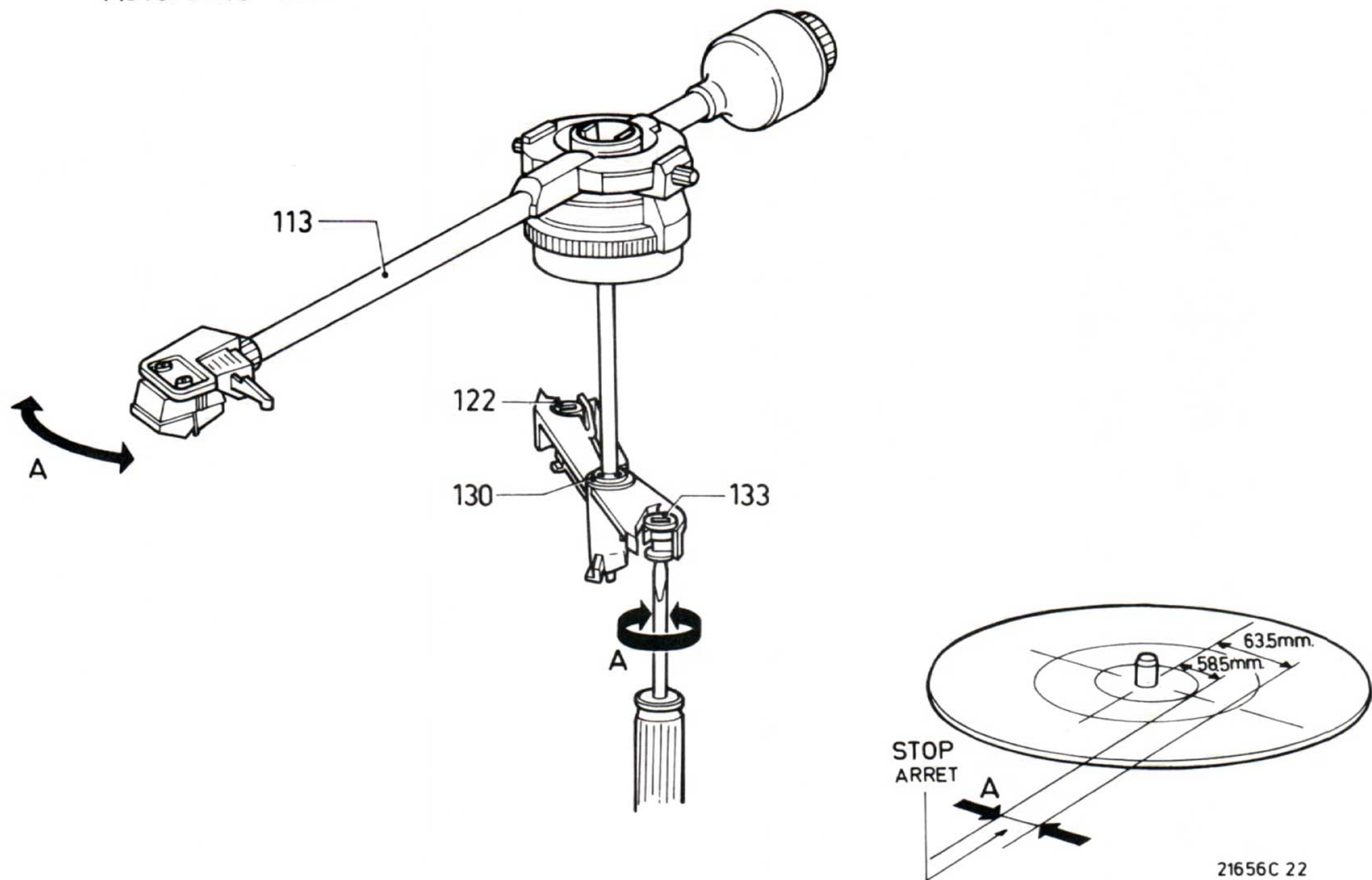

Fig. 2

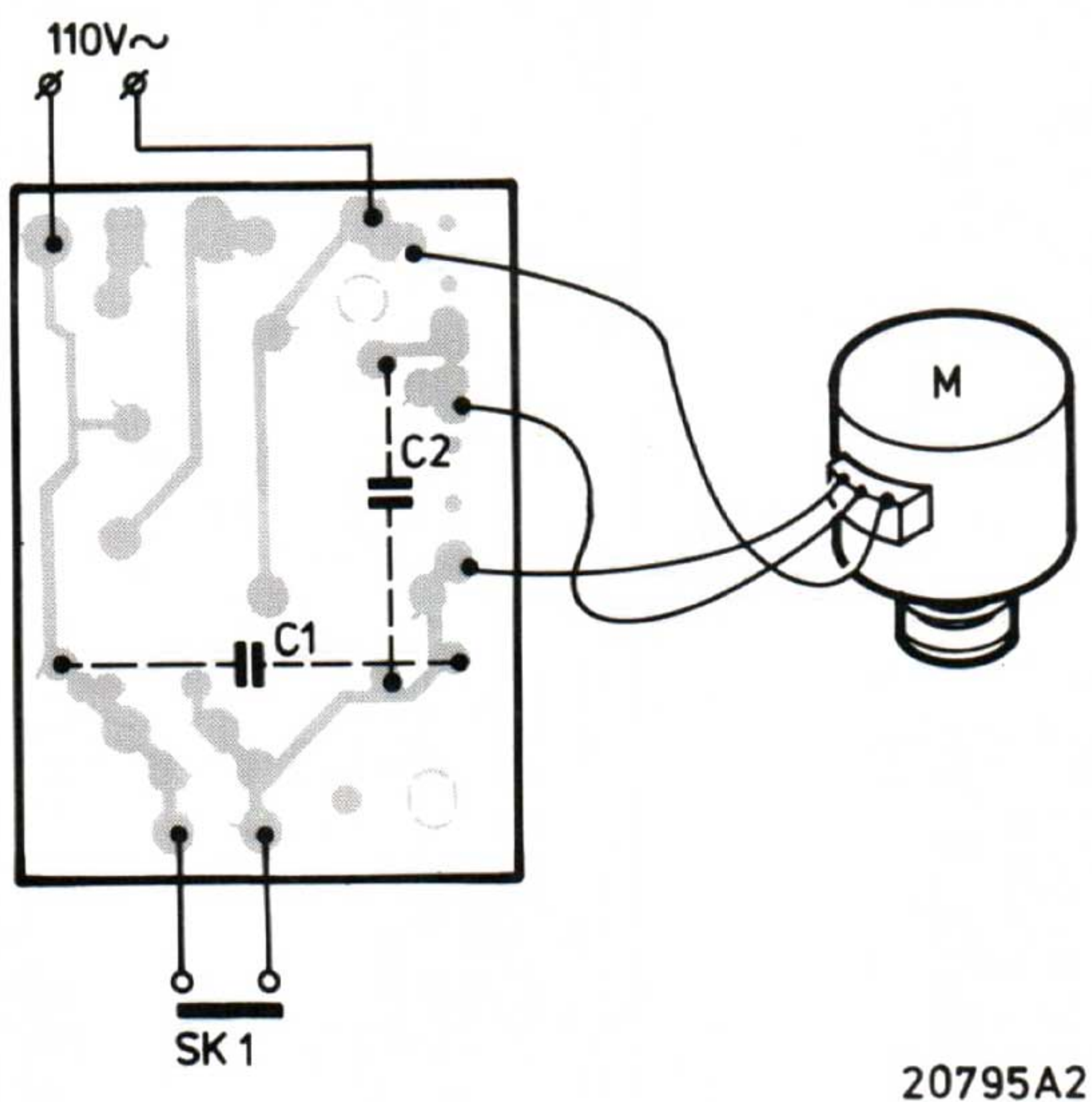

Fig. 3

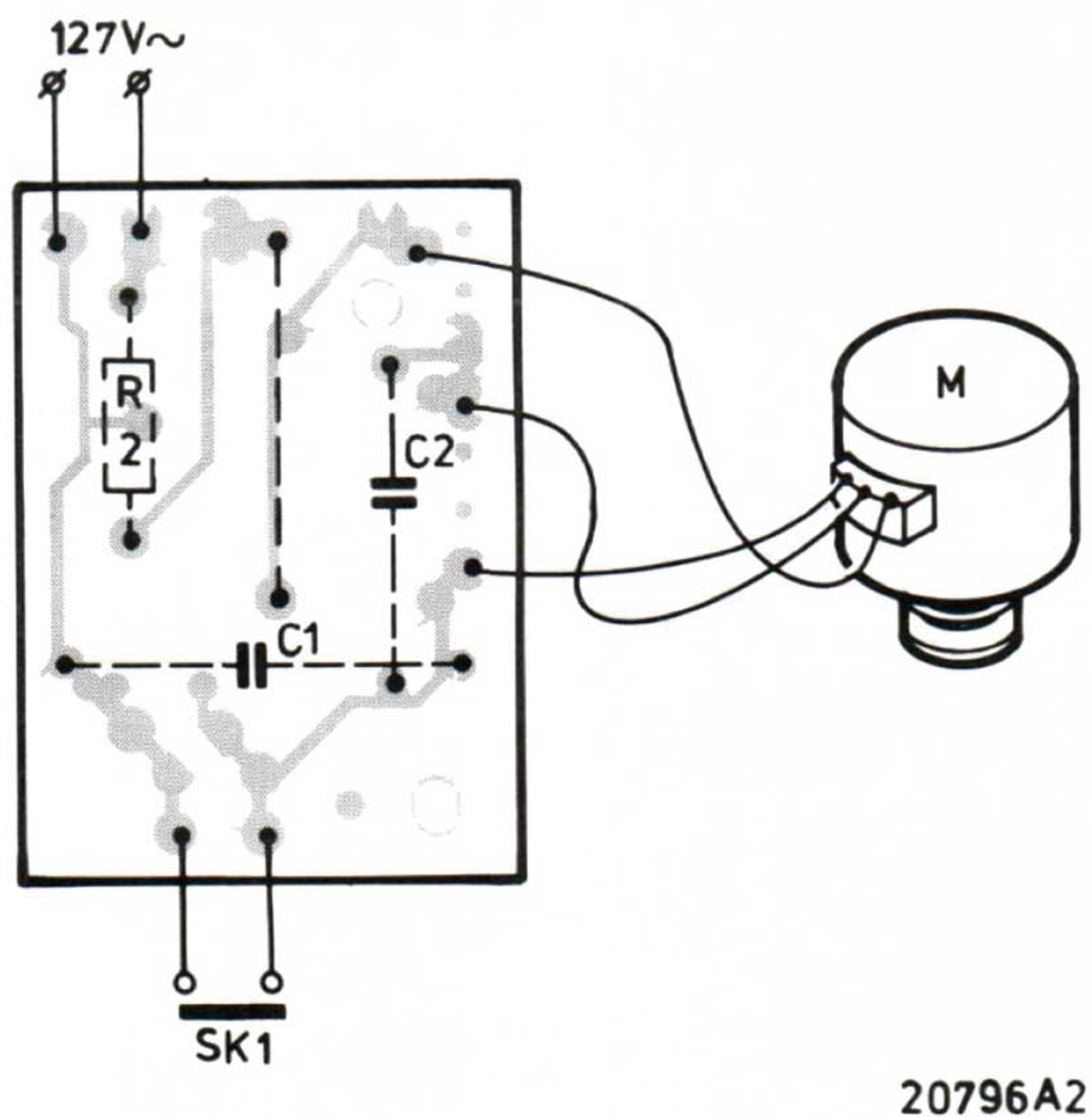

Fig. 4

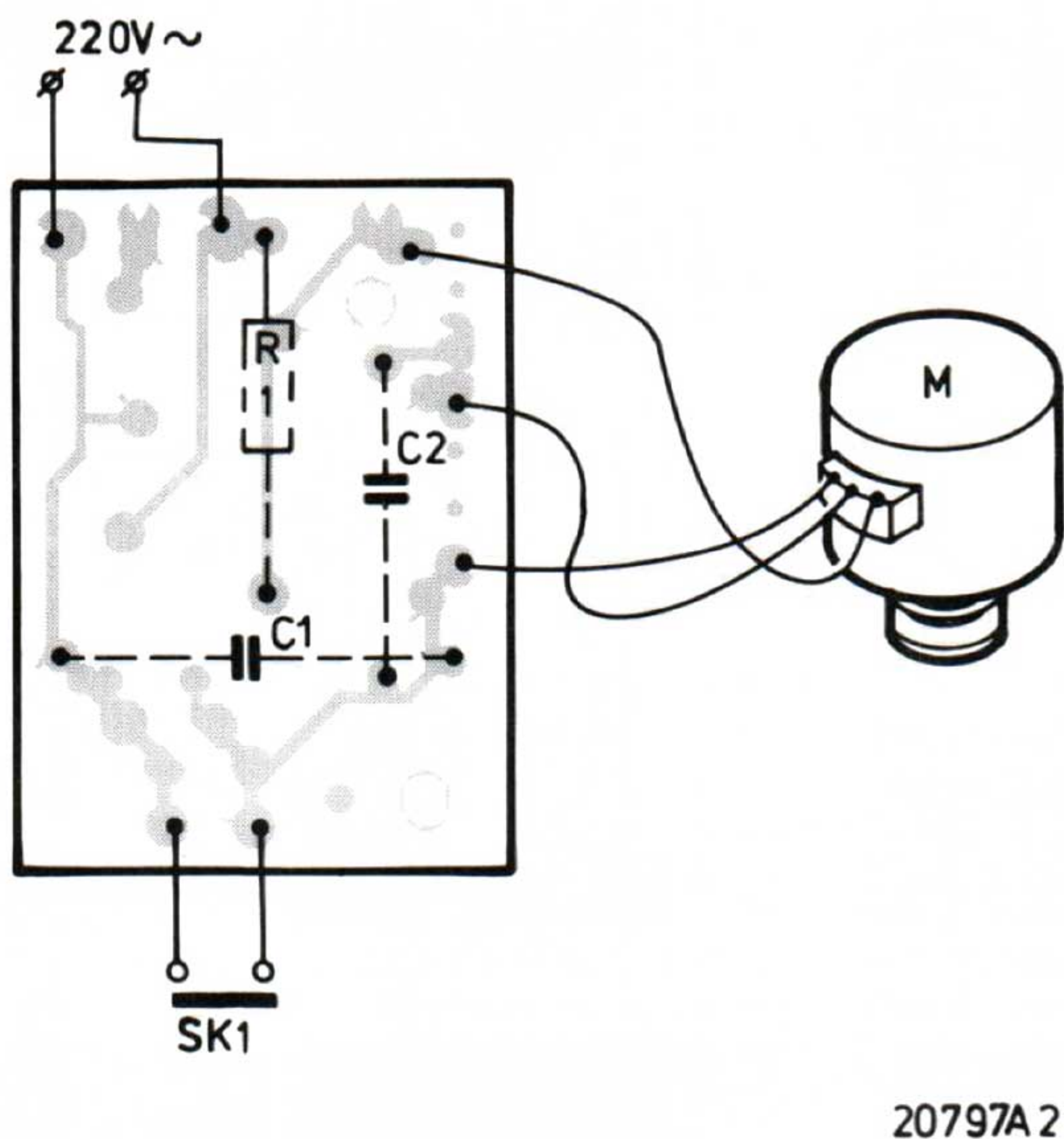

Fig. 5

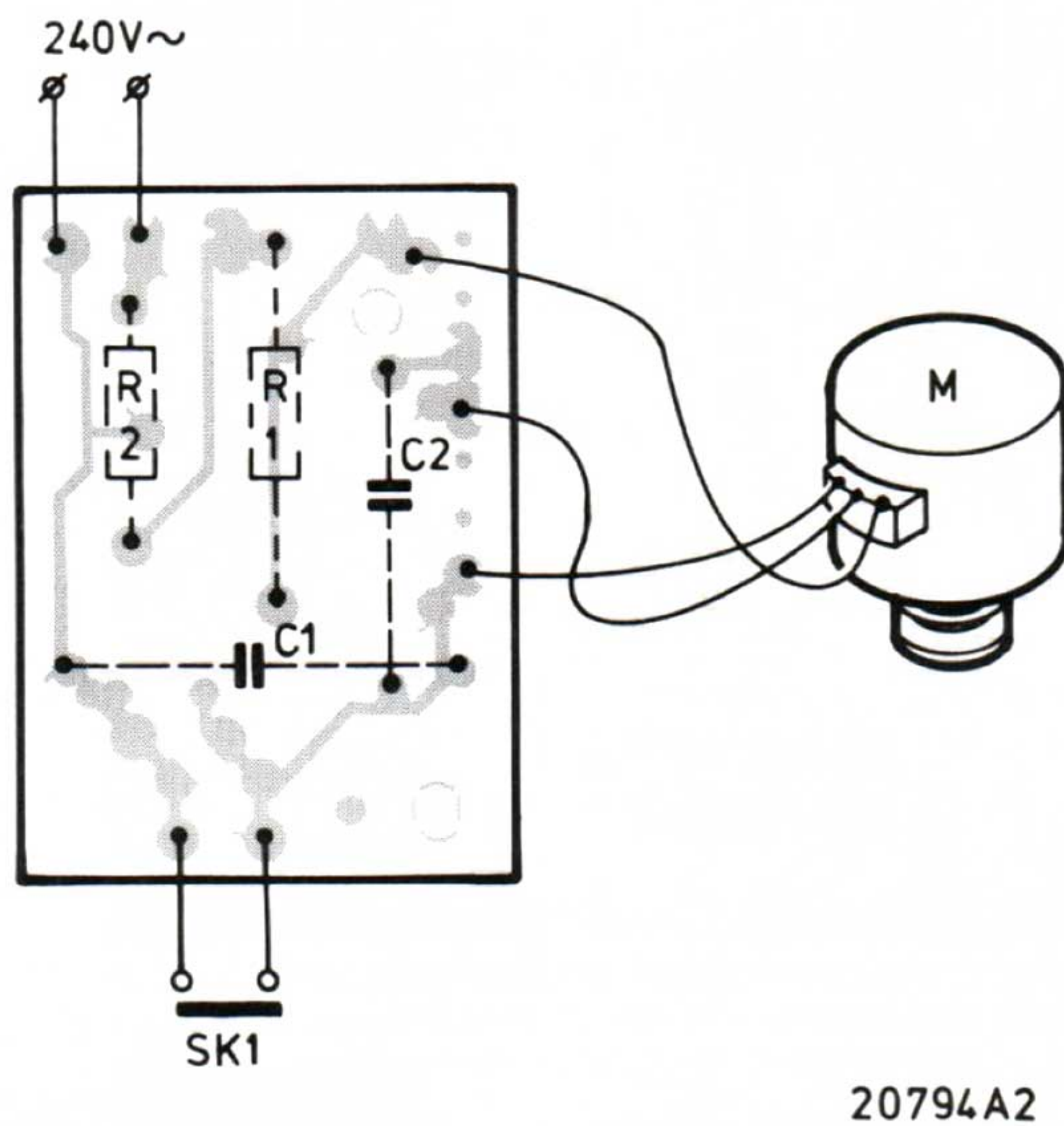

Fig. 6

R1 6.8 k Ω \pm 5% 5,5 W
 R2 1 k Ω \pm 5% 0,5 W
 C1 4700 pF \pm 20% 400 V
 C2 0,22 μ F \pm 10% 400 V

4822 112 41129
 4822 111 50143
 4822 122 10113
 4822 121 40181

Servicemededeling

PHILIPS NEDERLAND B.V. - EINDHOVEN
TECHNISCHE SERVICE

Ref. 476 PH

Type F 7112 Platenspeler

Datum september 1981

Betreft: A. Nieuwe pu arm pos. 113 en nieuwe pu arm as pos. 130
B. nieuwe motorvoedingsprint

A. Vanaf stempeling AH 01 - 113 is een nieuwe pu arm en pu arm-as toegepast.
Bestelnummer arm: 4822 251 70184
Bestelnummer as: 4822 535 60052

De oude uitvoering blijft leverbaar.

B. Vanaf week 115 is een nieuwe motor voedingsprint toegepast.
Zie hiervoor fig. 4,5,6 en 7.

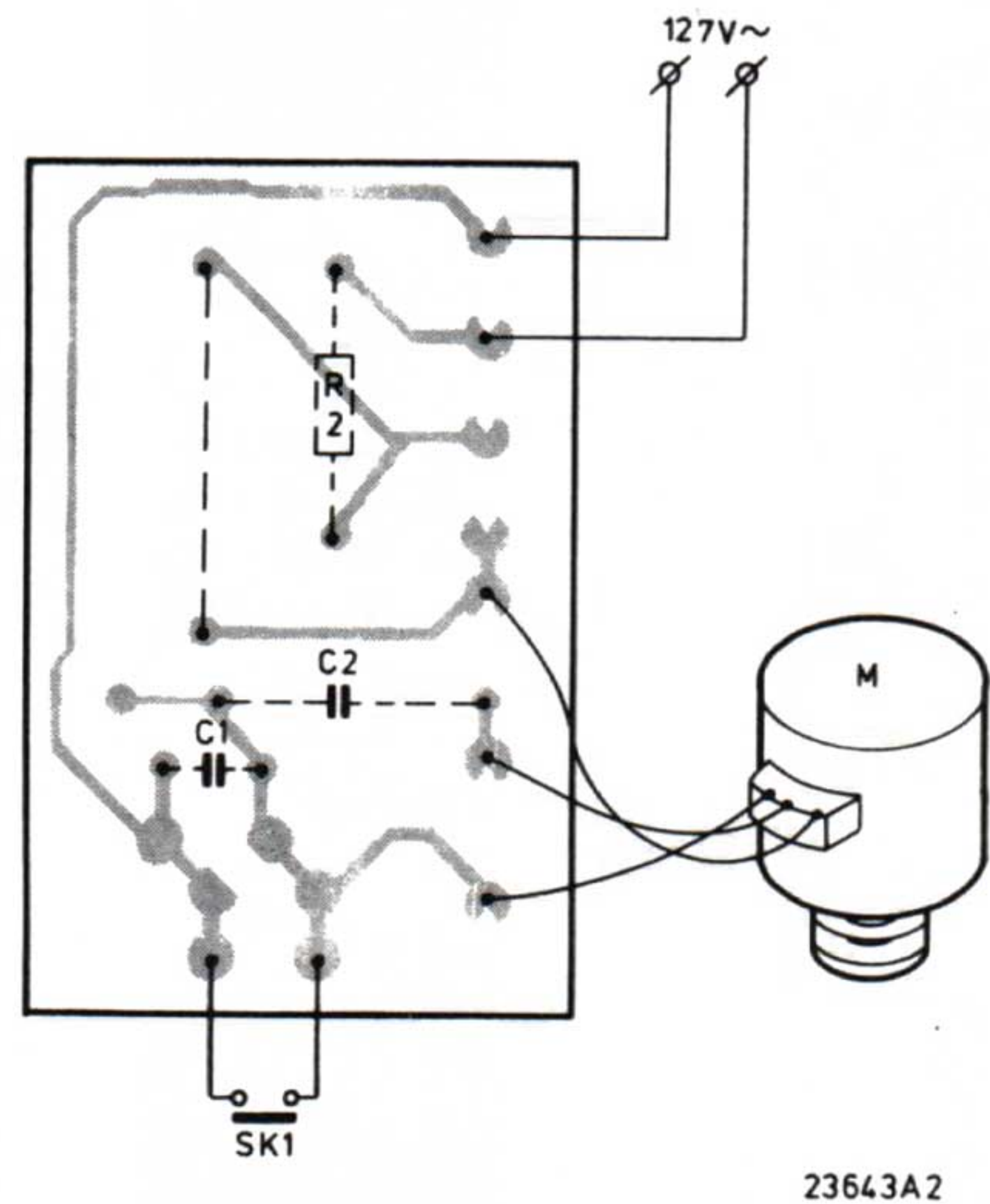
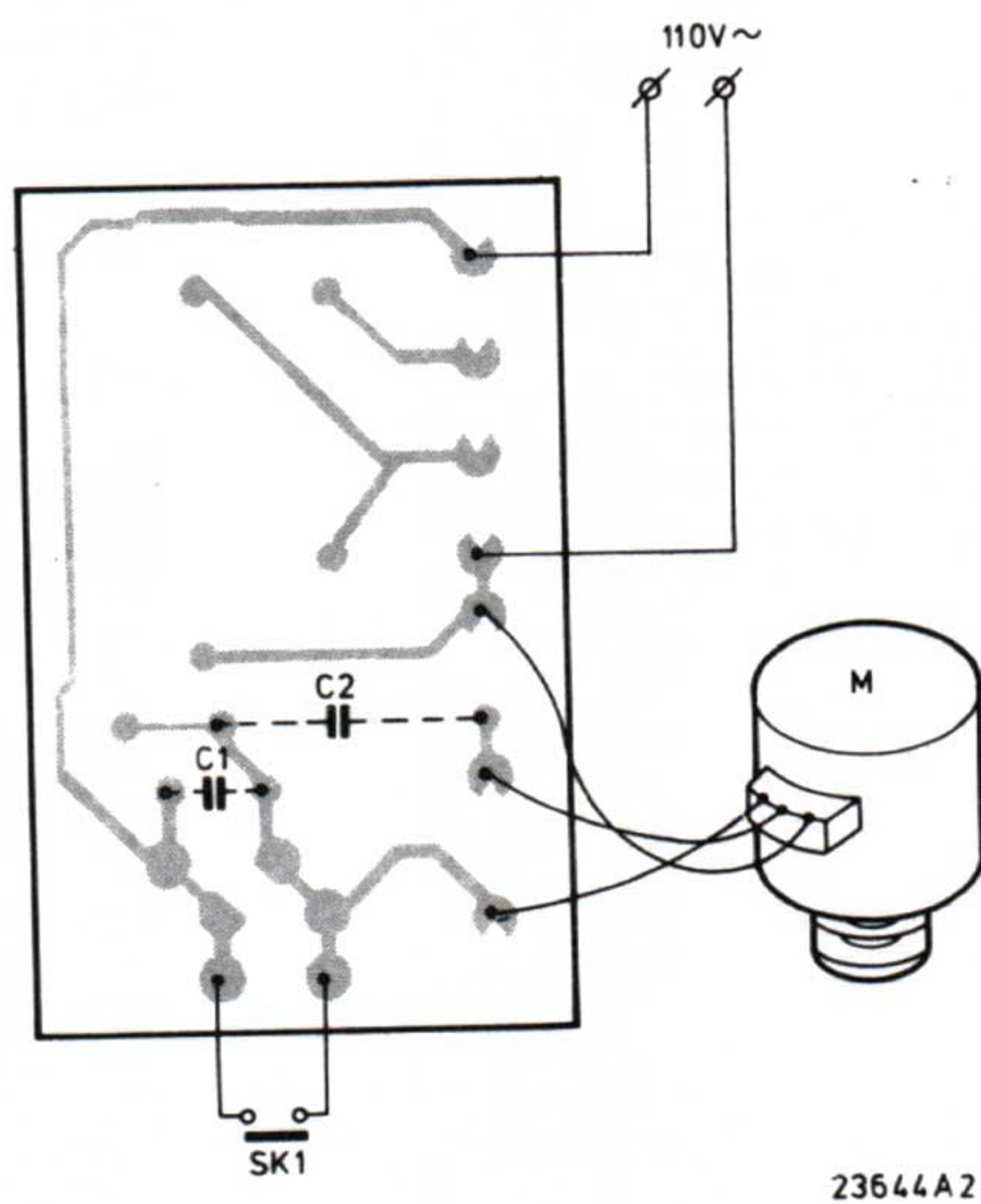

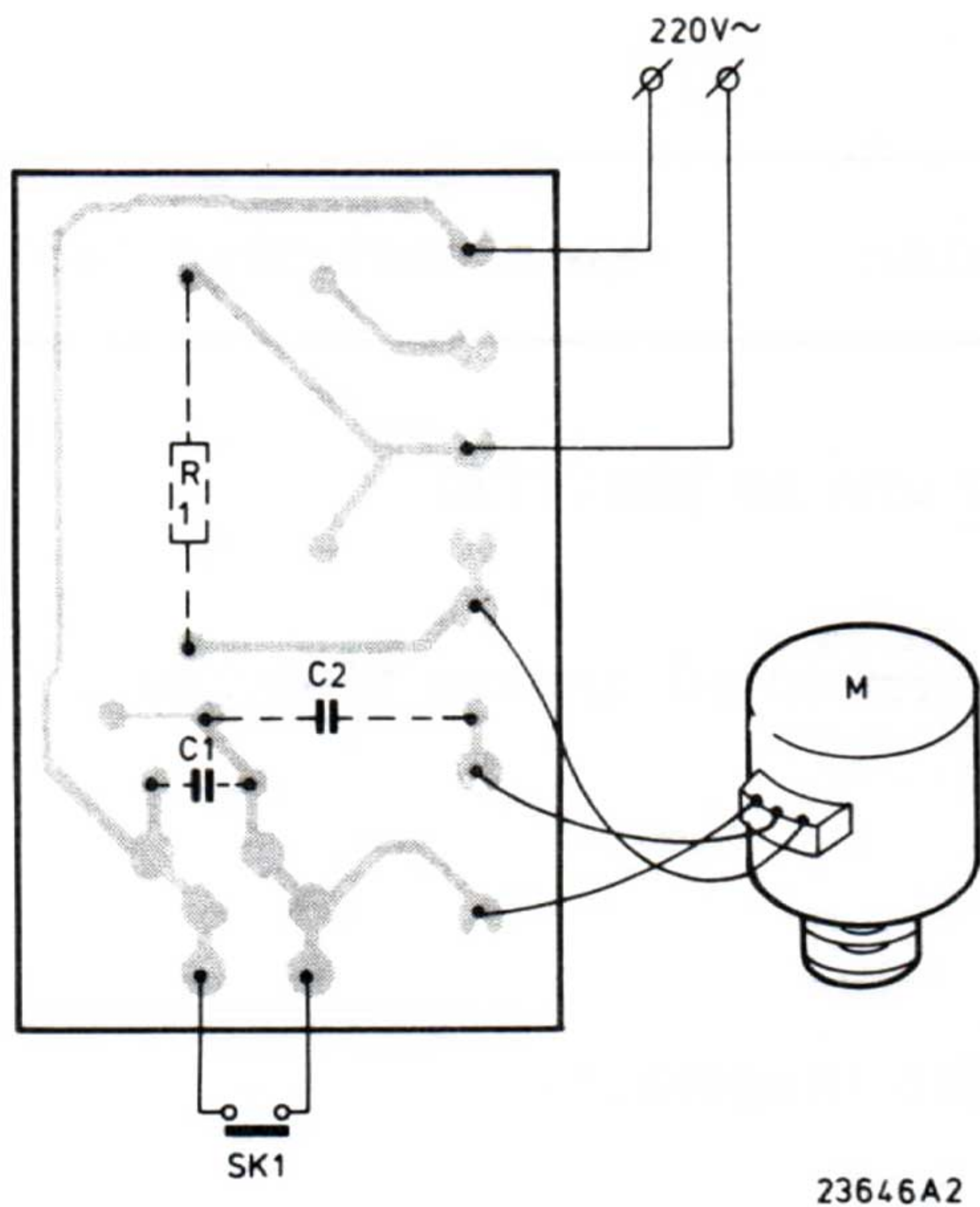

Fig. 6

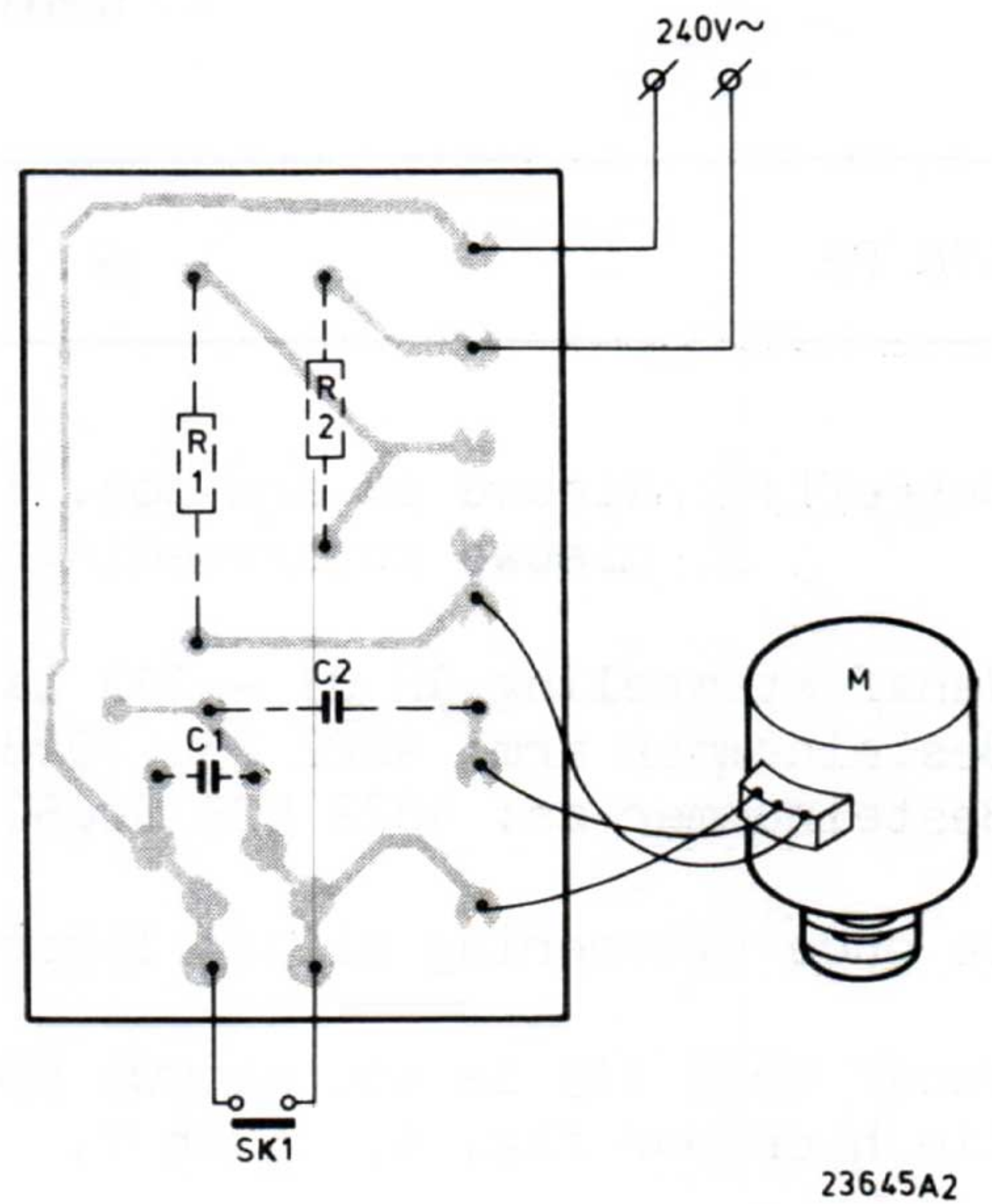

Fig. 7

| | | |
|------------|------------------------|----------------|
| R1 | 6.8 kΩ ± 5 % - 5.5 W | 4822 112 41129 |
| R2 | 1 kΩ ± 5 % - 0.5 W | 4822 111 50143 |
| C1 | 4700 pF ± 20 % - 400 V | 4822 122 10113 |
| C2 (50 Hz) | 0.82 μF ± 10 % - 400 V | 4822 121 40446 |
| C2 (60 Hz) | 0.68 μF ± 10 % - 400 V | 4822 121 40444 |
| M (50 Hz) | | 4822 361 20187 |
| M (60 Hz) | | 4822 361 20225 |