

TS320D-4

12" Titanic Mk IV Subwoofer 4 Ohm



Features

- 12" Kevlar-reinforced cone
- 2-1/2" edgewound voice coil
- Santoprene rubber surround
- Aluminum shorting ring
- Rigid 12-spoke cast frame
- Optimized motor structure
- Made in the USA

Parameters

Impedance (Ω)	4
Re (Ω)	3.30
Le (mH) @ 1 kHz	1.49
Fs (Hz)	24.2
Qms	5.443
Qes	0.445
Qts	0.411
Mms (g)	171.4
Cms (mm/N)	0.25
Sd (cm ²)	498
Vd (cm ³)	896
BL (Tm)	13.90
VAS (liters)	88.03
XMAX (mm)	18
VC Diameter (mm)	64
SPL (dB@1W/1m)	86.4
RMS Power Handling (w)	500
Usable Frequency Range (Hz)	24 - 500

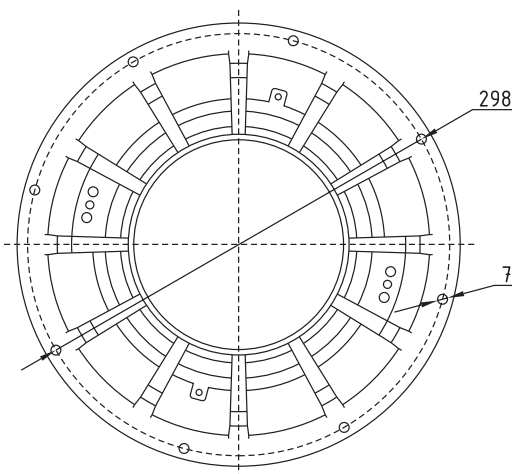
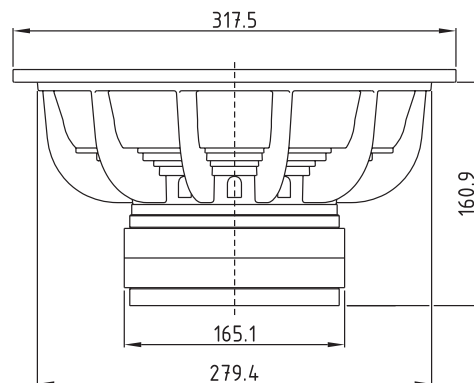

Note: All dimensions in mm.

Frequency Response

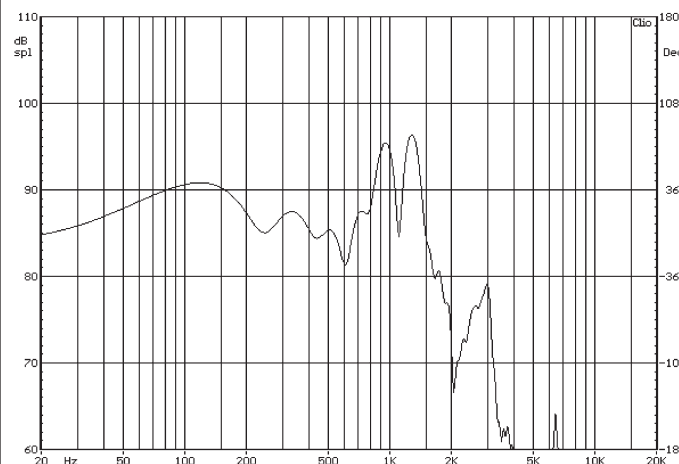

Note: Due to testing limitations, response below 200 Hz is not an actual representation.

Impedance/Phase

